

ELAN

Dış Ticaret Limited Şirketi



PRODUCT CATALOG

www.elantr.com

ELAN

Dış Ticaret Limited Şirketi



COMPANY

The motivation of Elan as a foreign trade company is to provide its clientele with a comprehensive range of mechanical & electrical installation products and building materials by collaborating with top performing manufacturers.

Elan is a distinctive representative of the strong commercial culture with its widespread contact points and foreign trade experience in emerging and developed markets. We take advantage of our network of both professional and personal relationships, along with our technical knowledge in order to supply a diverse range of M&E installation products and building materials to residential, commercial, hospitality, and mixed-use real estate.

We focus on a customer centric approach through building positive and trustworthy relationships with clients. By offering top quality products, propounding seamless and consistent customer experience, assuring proactive technical support pre-sale and post-sale, our aim is to further increase our clients' efficiency and effectiveness.

Elan Dış Ticaret is among the companies registered to the Turkish Exporters Assembly (TIM) and a proud member of the Ankara Chamber of Commerce.

PRODUCTS

- STEEL PIPES ■
- CAST IRON FITTINGS ■
- CARBON STEEL FITTINGS ■
- PIPES CLAMPS ■
- PROFILES & SECTIONS ■
- PLASTIC BASED PRODUCTS ■
- PLASTIC PIPES & FITTINGS ■
- FIRE SAFETY PRODUCTS ■
- VALVES ■
- INSULATION PRODUCTS ■
- CERAMIC TILES ■
- SANITARY WARE ■
- STAKEHOLDERS ■



STEEL PIPES

Çayırova Boru serves for over 35 years in the steel pipe sector with an annual 300,000 tons manufacturing capacity. Çayırova Boru manufactures oil pipes, natural gas pipes, water pipes, boiler pipes, general purpose pipes and structural hollow sections between 3/8" and 12 3/4" diameter range via the latest technology with experienced and trained staff. It has a very large product range including Galvanise Coating, Polyethylene Coating, Epoxy Coating, Internal Concrete Coating, Paint and Varnish and similar protective coatings. Çayırova Boru has Quality and Manufacturing Management Systems that are registered by internationally reputable audit corporations.

Quality Certificates

- TS EN 10255
- TS EN 10217-1-2-3
- TS EN ISO 3183
- TS 5139
- TS EN 10289
- TS EN 10298
- ISO 9001 (API)
- API SPECIFICATION Q1 (API)
- ISO 14001
- TS/OHSAS 18001

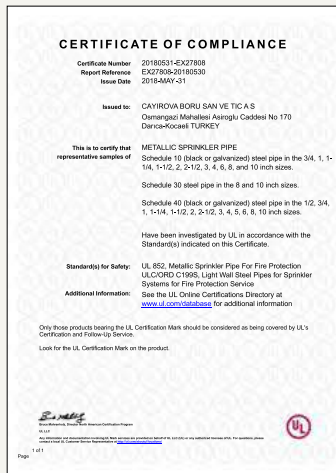
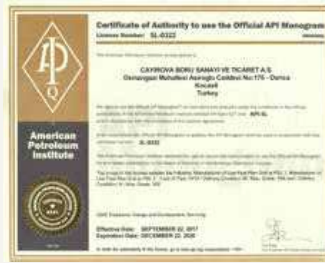

TS EN 10255			SU BORULARI - ORTA SERİ / WATER TUBES - MEDIUM SERIES				
Çap / Diameter			Et Kalınlığı Wall Thickness	Birim Ağırlık (kg/m) / Mass per Unit (kg/m)			
inch	mm	DN	mm	Siyah düz uçlu Black Plain End	Siyah dişli maşonlu Black Threaded & Coupled	Galvanizli düz uçlu Galvanized Plain End	Galvanizli dişli maşonlu Galvanized Threaded & Cou- pled
3/8	17,2	10	2,3	0,839	0,845	0,88	0,89
1/2	21,3	15	2,6	1,21	1,22	1,27	1,29
3/4	26,9	20	2,6	1,56	1,57	1,65	1,66
1	33,7	25	3,2	2,41	2,43	2,55	2,57
1 1/4	42,4	32	3,2	3,1	3,13	3,28	3,31
1 1/2	48,3	40	3,2	3,56	3,6	3,77	3,8
2	60,3	50	3,6	5,03	5,1	5,33	5,4
2 1/2	76,1	65	3,6	6,42	6,54	6,8	6,9
3	88,9	80	4	8,36	8,53	8,85	9
4	114,3	100	4,5	12,2	12,5	12,6	13
5	139,7	125	5,0	16,6	17,1	16,9	17,5
6	165,1	150	5,0	19,8	20,4	20,1	20,7

TS EN 10255			SU BORULARI - AĞIR SERİ / WATER TUBES - HEAVY SERIES				
Çap / Diameter			Et Kalınlığı Wall Thickness	Birim Ağırlık (kg/m) / Mass per Unit (kg/m)			
inch	mm	DN	mm	Siyah düz uçlu Black Plain End	Siyah dişli maşonlu Black Threaded & Coupled	Galvanizli düz uçlu Galvanized Plain End	Galvanizli dişli maşonlu Galvanized Threaded & Cou- pled
3/8	17,2	10	2,9	1,02	1,03	1,06	1,07
1/2	21,3	15	3,2	1,44	1,45	1,5	1,51
3/4	26,9	20	3,2	1,87	1,88	1,95	1,96
1	33,7	25	4,0	2,93	2,95	3,05	3,07
1 1/4	42,4	32	4,0	3,79	3,82	3,94	3,96
1 1/2	48,3	40	4,0	4,37	4,41	4,55	4,57
2	60,3	50	4,5	6,19	6,26	6,45	6,48
2 1/2	76,1	65	4,5	7,93	8,05	8,26	8,3
3	88,9	80	5,0	10,3	10,5	10,6	10,7
4	114,3	100	5,4	14,5	14,8	15	15,2
5	139,7	125	5,4	17,9	18,4	18,6	18,8
6	165,1	150	5,4	21,3	21,9	22,1	22,3

Su Boruları / Water Tubes

TS EN 10255			SU BORULARI - TİP L / WATER TUBES - TYPE L		
Çap / Diameter			Et Kalınlığı Wall Thickness	Birim Ağırlık (kg/m) / Mass per Unit (kg/m)	
inch	mm	DN		Siyah düz uçlu Black Plain End	Siyah dişli manşonlu Black Threaded & Coupled
3/8	17,2	10	2,0	0,75	0,756
1/2	21,3	15	2,3	1,05	1,09
3/4	26,9	20	2,3	1,4	1,41
1	33,7	25	2,9	2,2	2,22
1 1/4	42,4	32	2,9	2,82	2,85
1 1/2	48,3	40	2,9	3,25	3,29
2	60,3	50	3,2	4,51	4,58
2 1/2	76,1	65	3,2	5,75	5,87
3	88,9	80	3,2	6,76	6,93
4	114,3	100	3,6	9,83	10,1
5	139,7	125	4,5	15	15,5
6	165,1	150	4,5	17,8	18,4

TS EN 10255			SU BORULARI - TİP L 1 / WATER TUBES - TYPE L 1		
Çap / Diameter			Et Kalınlığı Wall Thickness	Birim Ağırlık (kg/m) / Mass per Unit (kg/m)	
inch	mm	DN		Siyah düz uçlu Black Plain End	Siyah dişli manşonlu Black Threaded & Coupled
3/8	17,2	10	2,0	0,742	0,748
1/2	21,3	15	2,3	1,08	1,09
3/4	26,9	20	2,3	1,39	1,4
1	33,7	25	2,9	2,2	2,22
1 1/4	42,4	32	2,9	2,82	2,85
1 1/2	48,3	40	2,9	3,24	3,28
2	60,3	50	3,2	4,49	4,56
2 1/2	76,1	65	3,2	5,73	5,85
3	88,9	80	3,6	7,55	7,72
4	114,3	100	4,0	10,8	11,1

TS EN 10255			SU BORULARI - TİP L 2 / WATER TUBES- TYPE L 2		
Çap / Diameter			Et Kalınlığı Wall Thickness	Birim Ağırlık (kg/m) / Mass per Unit (kg/m)	
inch	mm	DN		Siyah düz uçlu Black Plain End	Siyah dişli manşonlu Black Threaded & Coupled
3/8	17,2	10	1,8	0,67	0,676
1/2	21,3	15	2,0	0,947	0,956
3/4	26,9	20	2,3	1,38	1,39
1	33,7	25	2,6	1,98	2
1 1/4	42,4	32	2,6	2,54	2,57
1 1/2	48,3	40	2,9	3,23	3,27
2	60,3	50	2,9	4,08	4,15
2 1/2	76,1	65	3,2	5,71	5,83
3	88,9	80	3,2	6,72	6,89
4	114,3	100	3,6	9,75	10

TS EN 10217-1	SU BORULARI / WATER TUBES															
	Et Kalınlık / Wall Thickness (mm)															
Çap Diameter (mm)	1,8	2,0	2,3	2,6	2,9	3,2	3,6	4,0	4,5	5,0	5,6	6,3	7,1	8,0	8,8	10
17,2																
21,3																
26,9																
33,7																
42,4																
48,3																
51,0																
57,0																
60,3																
63,5																
73																
76,1																
88,9																
114,3																
139,7																
168,3																
193,7																
219,1																
244,5																
273,0																
323,9																



ASTM A53		SU VE GAZ BORULARI / WATER & GAS TUBES										
Çap Diameter		Et Kalınlık / Wall thickness			Birim Ağırlık / Mass per Unit				Test Basıncı / Test Pressure			
					Düz Uçlu / Plain End		Dişli Manşonlu / Threaded & Coupled		Gr A		Gr B	
inch	mm	inch	mm	Sch	lb/ft	kg/m	lb/ft	kg/m	psi	(bar)	psi	(bar)
3/8	17,2	0,091	2,31	40(STD)	0,57	0,84	0,57	0,84	700	48	700	48
1/2	21,3	0,109	2,77	40(STD)	0,85	1,27	0,86	1,27	700	48	700	48
3/4	26,9	0,113	2,87	40(STD)	1,13	1,69	1,14	1,69	700	48	700	48
1	33,7	0,113	2,38	40(STD)	1,68	2,50	1,69	2,50	700	48	700	48
1 1/4	42,4	0,14	3,56	40(STD)	2,27	3,39	2,28	3,40	1200	83	1300	90
1 1/2	48,3	0,145	3,68	40(STD)	2,72	4,05	2,74	4,04	1200	83	1300	90
2	60,3	0,154	3,91	40(STD)	3,66	5,44	3,68	5,46	2300	159	2500	172
2 1/2	73,0	0,203	5,16	40(STD)	5,8	8,63	5,85	8,67	2500	172	2500	172
3	88,9	0,125	3,18		4,51	6,72	4,61	6,78	1290	89	1500	100
		0,156	3,96		5,58	8,29	5,68	8,35	1600	110	1870	129
		0,188	4,78		6,66	9,92	6,76	9,98	1930	133	2260	156
		0,216	5,49	40(STD)	7,58	11,29	7,68	11,35	2220	153	2500	172
		0,250	6,35		8,69	12,93	8,79	13,00	2250	155	2500	172
3 1/2	101,6	0,125	3,18		5,18	7,72	5,33	7,86	1120	77	1310	90
		0,156	3,96		6,41	9,53	6,56	9,67	1400	97	1640	113
		0,188	4,78		7,66	11,41	7,81	11,55	1690	117	1970	136
		0,226	5,74	40(STD)	9,12	13,57	9,27	13,71	2030	140	2370	163
4	114,3	0,125	3,18		5,85	8,71	5,97	8,87	1000	69	1170	81
		0,156	3,96		7,24	10,78	7,36	10,94	1250	86	1460	101
		0,188	4,78		8,67	12,91	8,79	13,07	1500	103	1750	121
		0,219	5,56		10,02	14,91	10,14	15,07	1750	121	2040	141
		0,237	6,02	40(STD)	10,80	16,07	10,92	16,23	1900	131	2210	152
		0,250	6,35		11,36	16,90	11,48	17,06	2000	138	2330	161
5	141,3	0,188	4,78		10,80	16,09	11,07	16,39	1220	84	1420	98
		0,219	5,56		12,51	18,61	12,78	18,91	1420	98	1650	114
		0,258	6,55	40(STD)	14,63	21,77	14,90	22,07	1670	115	1950	134
		0,281	7,14		15,87	23,62	16,14	23,92	1820	125	2120	146
6	168,3	0,188	4,78		12,94	19,27	13,29	19,59	1020	70	1190	82
		0,219	5,56		15,00	22,31	15,35	22,63	1190	82	1390	96
		0,250	6,35		17,04	25,36	17,39	25,68	1360	94	1580	109
		0,280	7,11	40(STD)	18,99	28,26	19,34	28,58	1520	105	1780	123
		0,312	7,92		21,06	31,32	21,41	31,64	1700	117	1980	137
8	219,1	0,188	4,78		16,96	25,26			780	54	920	63
		0,203	5,16		18,28	27,22			850	59	1000	69
		0,219	5,56		19,68	29,28			910	63	1070	74
		0,250	6,35	20	22,38	33,31			1040	72	1220	84
		0,277	7,04	30	24,72	36,31			1160	78	1350	93
		0,312	7,92		27,73	41,24			1300	90	1520	105
		0,322	8,18	40(STD)	28,58	42,55			1340	92	1570	108
		0,344	8,74		30,45	45,34			1440	99	1680	116
10	273,0	0,188	4,78		21,23	31,62			630	43	730	50
		0,203	5,16		22,89	34,08			680	47	800	55
		0,219	5,56		24,65	36,67			730	50	860	59
		0,250	6,35	20	28,06	41,75			840	58	980	68
		0,279	7,09		31,23	46,49			930	64	1090	75
		0,307	7,8	30	34,27	51,01			1030	71	1200	83
		0,348	8,74		38,70	56,96			1150	79	1340	92
		0,365	9,27	40(STD)	40,52	60,29			1220	84	1430	99
12	323,8	0,203	5,16		27,23	40,55			570	39	670	46
		0,219	5,56		29,34	43,63			620	43	720	50
		0,250	6,35	20	33,41	49,71			710	49	820	57
		0,281	7,14		37,46	55,75			790	54	930	64
		0,312	7,92		41,48	61,69			880	61	1030	71
		0,330	8,38	30	43,81	65,18			930	64	1090	75
		0,344	8,74		45,62	67,90			970	67	1130	78
		0,375	9,52	STD	49,61	73,78			1060	73	1240	85
0,406	10,31	40	53,57	79,70			1150	79	1340	92		

ASTM A795		YANGIN BORULARI / SPRINKLER TUBES								
Çap Diameter		Et Kalınlık / Wall thickness			Birim Ağırlık / Mass per Unit				Test Basıncı / Test Pressure	
					Düz Uçlu / Plain End		Dişli Mansonlu / Threaded & Coupled			
inch	mm	inch	mm	Sch	lb/ft	kg/m	lb/ft	kg/m	psi	(bar)
3/4	26,7	0,083	2,11	10	1,41	2,09			700	48
		0,113	2,87	40	1,13	1,69	1,13	1,68	700	48
1	33,4	0,109	2,77	10	1,41	2,09			700	48
		0,133	3,38	40	1,68	2,5	1,68	2,50	700	48
1 1/4	42,2	0,109	2,77	10	1,81	2,69			1000	69
		0,140	3,56	40	2,27	3,39	2,28	3,40	1000	69
1 1/2	48,3	0,109	2,77	10	2,09	3,11			1000	69
		0,145	3,68	40	2,72	4,05	2,73	4,07	1000	69
2	60,3	0,109	2,77	10	2,64	3,93			1000	69
		0,154	3,91	40	3,66	5,45	3,69	5,50	1000	69
2 1/2	73,0	0,120	3,05	10	3,53	5,26			1000	69
		0,203	5,16	40	5,80	8,64	5,83	8,68	1000	69
3	88,9	0,120	3,05	10	4,34	6,46			1000	69
		0,126	5,49	40	7,58	11,29	7,62	11,35	1000	69
3 1/2	101,6	0,120	3,05	10	4,98	7,41			1200	83
		0,226	5,74	40	9,12	13,58	9,21	13,71	1200	83
4	114,3	0,120	3,05	10	5,62	8,37			1200	83
		0,237	6,02	40	10,80	16,09	10,91	16,25	1200	83
5	141,3	0,134	3,4	10	7,78	11,58			1200	83
		0,258	6,55	40	14,63	21,79	14,82	22,07	1200	83
6	168,3	0,134	3,4	10	9,30	13,85			1000	69
		0,280	7,11	40	18,99	28,29	19,20	28,60	1200	83
8	219,1	0,188	4,78		16,96	25,26			800	55
		0,277	7,04	30	24,72	36,82			1200	83
10	273,0	0,188	4,78		21,23	31,62			700	48
		0,307	7,8	30	34,27	51,05			1000	69

YİVLİ BORULARI / ROLL GROOVED TUBES

Çap Diameter		Çap Toleransı / Diameter Tolerance		Conta Yuvası / Seal Seat	Yiv Genişliği / Groove Width	Yiv Çapı / Groove Diameter		Yiv Derinliği / Groove Depth	Minimum Et Kalınlık / Minimum Wall Thickness	Boru Ucu Çapı / Pipe End Diameter
inch (DN)	inch mm	(+) mm	(-) mm	(A) ±0.76 mm	(B) ±0.76 mm	(C) Nominal	(C) +0,00	(D) mm	(T) mm	(F) mm
3/4	1,050									
20	26,7	0,25	0,25	15,88	7,14	23,83	-0,38	1,5	1,6	29,2
1	1,315									
25	33,7	0,33	0,33	15,88	7,14	30,23	-0,38	1,60	1,6	36,3
1 1/4	1,660									
32	42,4	0,41	0,41	15,88	7,14	38,99	-0,38	1,60	1,6	45,0
1 1/2	1,900									
40	48,3	0,48	0,48	15,88	7,14	45,09	-0,38	1,60	1,6	51,1
2	2,375									
50	60,3	0,61	0,61	15,88	8,74	57,15	-0,38	1,60	1,6	63,0
2 1/2	2,875									
65	73	0,74	0,74	15,88	8,74	69,09	-0,38	1,60	1,6	75,7
	3,000									
76,1mm	76,1	0,76	0,76	15,88	8,74	72,26	-0,46	1,98	2,0	78,7
3	3,500									
80	88,9	0,89	0,89	15,88	8,74	84,94	-0,46	1,98	2,0	91,4
3 1/2	4,000									
90	101,6	1,02	0,79	15,88	8,74	97,38	-0,51	2,11	2,0	104,1
4	4,500									
100	114,3	1,14	0,79	15,88	8,74	110,08	-0,51	2,11	2,11	116,8
	4,25									
133,0mm	133,0	1,35	0,79	15,88	8,74	129,13	-0,51	2,11	2,77	135,9
5 1/2	5,500									
139,7mm	139,7	1,42	0,79	15,88	8,74	135,48	-0,51	2,11	2,77	142,2
5 9/16	5,563									
125	141,3	1,60	0,79	15,88	8,74	137,03	-0,56	2,13	2,77	143,8
	6,500									
165,1	165,1	1,60	0,79	15,88	8,74	160,78	-0,56	2,16	2,77	167,6
6	6,625									
150	168,3	1,60	0,79	15,88	8,74	163,96	-0,56	2,16	2,77	170,9
8	8,625									
200	219,1	1,60	0,79	15,88	11,91	214,4	-0,64	2,34	2,77	223,5
10	10,750									
250	273	1,60	0,79	15,88	11,91	268,28	-0,69	2,39	3,40	277,4
12	12,750									
300	323,9	1,60	0,79	15,88	11,91	318,29	-0,76	2,77	3,96	328,2

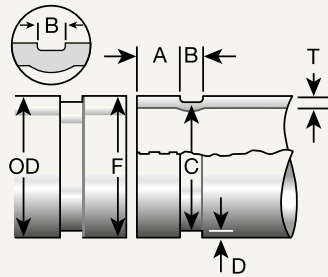

TS EN 10217-2	YÜKSEK SICAKLIK ÖZELLİKLERİ OLAN BASINÇ AMAÇLI BORULAR (KAZAN BORULARI) / WELDED STEEL WATER TUBES FOR PRESSURE PURPOSES (BOILER TUBES)															
	Et Kalınlık / Wall Thickness (mm)															
Çap Diameter (mm)	1,8	2,0	2,3	2,6	2,9	3,2	3,6	4,0	4,5	5,0	5,6	6,3	7,1	8,0	8,8	10
33,7																
42,4																
48,3																
51,0																
57,0																
60,3																
63,5																
73																
76,1																
88,9																
114,3																
139,7																
168,3																
193,7																
219,1																
244,5																
273,0																
323,9																

TS EN 10217-3	BETON POMPA BORULARI / CONCRETE PUMP TUBES									
	Malzeme Steel Grade	Dış Çap (mm) Outside Diameter	Et Kalınlığı (mm) Wall Thickness	Boy (m) Length	Kalite	Standart	Boru Ucu	Yüzey	Isıt İşlem	Hidrostatik Test
ST52, P355	133	4,0	6-12	S355J2	EN 10217-1	Düz Uçlu	Boyalı / Boyasız	"Dikiş Tavlı (870-930 °C)"	Min. 203 Bar	% 100 UT (Ultrasonik Test)
	133	4,5	6-12	P355NH	EN 10217-3	Düz Uçlu	Boyalı / Boyasız	"Dikiş Tavlı (870-930 °C)"	Min. 203 Bar	% 100 UT (Ultrasonik Test)

MEKANİK ÖZELLİKLER					
Standart	Kalite	Min. Akma Dayanımı Re (N/mm ²)	Çekme Dayanımı Rm (N/mm ²)	% Uzama (min.)	Darbe Deneyi Özellikleri
EN 10025-2	S355J2	355	470-630	20	27 J (-20 °C)
EN 10028-3	P355NH	355	490-630	22	30 J (-20 °C)



Petrol ve Doğalgaz Boruları / Oil & Natural Gas Tubes

API 5L / TS EN ISO 3183		PETROL VE DOĞALGAZ BORULARI / OIL & NATURAL GAS TUBES										
Çap Diameter		Et Kalınlık / Wall thickness		Birim Ağırlık / Mass per Unit		Test Basıncı / Test Pressure						
						A	B	X42	X46	X52	X56	X60
inch	mm	inch	mm	lb/ft	kg/m	L210 bar	L245 bar	L290 bar	L320 bar	L360 bar	L390 bar	L415 bar
1/2	21,3	0,109	2,8	0,85	1,28	170	170					
3/4	26,7	0,113	2,9	1,13	1,70	170	170					
1	33,4	0,133	3,4	1,68	2,52	170	170					
1 1/4	42,2	0,14	3,6	2,27	3,43	170	170					
1 1/2	48,3	0,145	3,7	2,72	4,07	170	170					
2	60,3	0,125	3,2	3,01	4,51	134	156					
		0,141	3,6	3,37	5,03	150	170	205	205	205	205	205
		0,154	3,9	3,66	5,42	163	170	205	205	205	205	205
		0,172	4,4	4,05	6,07	170	170	205	205	205	205	205
		0,188	4,8	4,40	6,57	170	170	205	205	205	205	205
2 1/2	73	0,203	5,2	4,71	7,07	170	170	205	205	205	205	205
		0,125	3,2	3,67	5,51	110	129	153	168	189	205	205
		0,141	3,6	4,12	6,16	124	145	172	189	205	205	205
		0,156	4	4,53	6,81	138	161	191	205	205	205	205
		0,172	4,4	4,97	7,44	152	170	205	205	205	205	205
		0,188	4,8	5,40	8,07	166	170	205	205	205	205	205
		0,203	5,2	5,80	8,69	170	170	205	205	205	205	205
3	88,9	0,216	5,5	6,14	9,16	170	170	205	205	205	205	205
		0,125	3,2	4,51	6,76	91	106	125	138	156	168	179
		0,141	3,6	5,06	7,57	102	119	141	156	175	190	202
		0,156	4	5,58	8,37	113	132	157	173	194	205	205
		0,172	4,4	6,12	9,17	125	146	172	190	205	205	205
		0,188	4,8	6,66	9,95	136	159	188	205	205	205	205
3 1/2	101,6	0,216	5,5	7,58	11,31	156	170	205	205	205	205	205
		0,250	6,4	8,69	13,02	170	170	205	205	205	205	205
		0,125	3,2	5,18	7,76	79	93	110	121	136	147	157
		0,141	3,6	5,82	8,70	89	104	123	136	153	166	176
		0,156	4	6,41	9,63	99	116	137	151	170	184	196
		0,172	4,4	7,04	10,55	109	127	151	166	187	203	205
		0,188	4,8	7,66	11,46	119	139	164	181	204	205	205
		0,226	5,7	9,12	13,48	141	165	195	205	205	205	205



Petrol ve Doğalgaz Boruları / Oil & Natural Gas Tubes

API 5L/TS EN ISO 3183		PETROL VE DOĞALGAZ BORULARI / OIL & NATURAL GAS TUBES										
Çap Diameter		Et Kalınlık / Wall thickness		Birim Ağırlık / Mass per Unit		Test Basıncı / Test Pressure						
						A	B	X42	X46	X52	X56	X60
inch	mm	inch	mm	lb/ft	kg/m	L210 bar	L245 bar	L290 bar	L320 bar	L360 bar	L390 bar	L415 bar
4	114,3	0,141	3,6	6,57	9,83	79	93	110	121	136	147	157
		0,156	4	7,24	10,88	88	103	122	134	151	164	174
		0,172	4,4	7,96	11,92	97	113	134	148	166	180	192
		0,188	4,8	8,67	12,96	106	123	146	161	181	197	205
		0,203	5,2	9,32	13,99	115	134	158	175	197	205	205
		0,219	5,6	10,02	15,01	123	144	170	188	205	205	205
		0,237	6	10,80	16,02	132	154	183	202	205	205	205
5	141,3	0,188	4,8	10,80	16,16	86	100	118	130	147	159	169
		0,219	5,6	12,51	18,74	100	117	138	152	171	185	197
		0,258	6,6	14,63	21,92	118	137	163	179	202	205	205
		0,281	7,1	15,87	23,50	127	148	175	193	205	205	205
6	168,3	0,172	4,4	11,87	17,78	66	77	114	125	141	153	163
		0,188	4,8	12,94	19,35	72	84	124	137	154	167	178
		0,203	5,2	13,94	20,91	78	91	134	148	167	181	192
		0,219	5,6	15,00	22,47	84	98	145	160	180	195	205
		0,250	6,4	17,04	25,55	96	112	165	183	205	205	205
		0,28	7,1	18,99	28,22	106	124	184	202	205	205	205
8	219,1	0,312	7,9	21,06	31,25	118	138	204	205	205	205	205
		0,188	4,8	16,96	25,37	55	64	95	105	118	128	136
		0,203	5,2	18,28	27,43	60	70	103	114	128	139	148
		0,219	5,6	19,68	29,48	64	75	111	123	138	150	159
		0,250	6,4	22,38	33,57	74	86	127	140	158	171	182
		0,277	7	24,72	36,61	81	94	139	153	173	187	199
		0,312	7,9	27,73	41,14	91	106	157	173	195	205	205
10	273,1	0,322	8,2	28,58	42,65	94	110	163	180	202	205	205
		0,344	8,7	30,45	45,14	100	117	173	191	205	205	205
		0,203	5,2	22,89	34,35	48	56	94	104	117	126	135
		0,219	5,6	24,65	36,94	52	60	101	112	125	136	145
		0,250	6,4	28,06	42,09	59	69	116	127	143	155	165
		0,279	7,1	31,23	46,57	66	76	128	141	159	172	183
		0,307	7,8	34,27	51,03	72	84	141	155	175	189	201
12	323,9	0,348	8,7	38,70	56,72	80	94	157	173	195	205	205
		0,365	9,3	40,52	60,50	86	100	168	185	205	205	205
		0,203	5,2	27,23	40,87	40	47	79	87	98	106	113
		0,219	5,6	29,34	43,96	44	51	85	94	106	115	122
		0,250	6,4	33,41	50,11	50	58	97	107	121	131	139
		0,281	7,1	37,46	55,47	55	64	108	119	134	145	155
		0,312	7,9	41,48	61,56	61	72	120	133	149	162	172
		0,330	8,4	43,81	65,35	65	76	128	141	159	172	183
		0,344	8,7	45,62	67,62	68	79	132	146	164	178	189
		0,375	9,5	49,61	73,65	74	86	145	160	179	194	205
		0,406	10,3	53,57	79,65	80	93	157	173	195	205	205

Sondaj Boruları / Casing & Tubing Tubes

API 5 CT		SONDAJ BORULARI / CASING & TUBING TUBES					
Çap / Diameter		Et Kalınlığı Wall Thickness	Birim Ağırlık / Mass per Unit	Test Basıncı / Test Pressure			
inch	mm			mm	(kg/m)	H40 psi	H40 bar
2-3/8	60,32	4,24	5,87	4500	310	6200	425
		4,83	6,61	5100	355	7000	485
2-7/8	73,02	5,51	9,17	4800	335	6600	460
3-1/2	88,90	5,49	11,29	3900	275	5400	375
		6,45	13,12	4600	320	6400	440
		7,34	14,76	5300	365	7300	500
4	101,60	5,74	13,57	3600	250	5000	345
		6,65	15,57	4200	290	5800	395
4-1/2	114,30	6,88	18,23	3900	265	5300	365

API 5 CT		SONDAJ BORULARI / CASING & TUBING TUBES					
Çap / Diameter		Et Kalınlığı Wall Thickness	Birim Ağırlık / Mass per Unit	Test Basıncı / Test Pressure			
inch	mm			mm	(kg/m)	H40 psi	H40 bar
4-1/2	114,30	5,21	14,02	2900	200	4000	275
		5,69	15,24	-	-	4400	300
		6,35	16,91	-	-	4900	335
5	127,00	5,59	16,74	-	-	3900	265
		6,43	19,12	-	-	4500	305
		7,52	22,16	-	-	5200	360
5-1/2	139,70	6,20	20,41	2800	195	3900	270
		6,98	22,85	-	-	4400	305
		7,72	25,13	-	-	4900	335
6-5/8	168,28	7,32	29,06	2800	190	3800	265
		8,94	35,13	-	-	4700	320
7	177,80	5,87	24,89	2100	145	-	-
		6,91	29,12	2500	170	3400	235
		8,05	33,70	-	-	4000	275
		9,19	38,21	-	-	4600	315
7-5/8	193,68	7,62	34,96	2500	175	-	-
		8,33	38,08	-	-	3800	260
8-5/8	219,08	6,71	35,14	-	-	2700	185
		7,72	40,24	2300	155	-	-
		8,94	46,33	2600	180	3600	245
		10,16	52,35	-	-	4100	280
9-5/8	244,48	7,92	46,20	2100	145	-	-
		8,94	51,93	2300	160	3200	220
		10,03	57,99	-	-	3600	250
10-3/4	273,05	7,09	46,50	1200	85	-	-
		8,89	57,91	1600	110	2100	150
		10,16	65,87	-	-	2500	170

TS EN 10219		YAPI PROFİLLERİ / CONSTRUCTION PROFILES				
Ebat Size	(mm)	Et Kalınlık / Wall thickness (mm)				
		5	6	6,3	8	10
		Birim Ağırlık / Mass Per Unit, (kg/m)				
200 x 200		30,1	35,8	37,2	46,5	57
250 x 150		30,1	35,8	37,2	46,5	57
250 x 250		38,0	45,2	47,1	59,1	72,7
300 x 200		38,0	45,2	47,1	59,1	72,7



CAST IRON FITTINGS

Trakya Döküm, with its modern production facilities and experienced personnel, is the leading malleable cast iron fitting manufacturer in Turkey, producing fittings compliant with EN10242 Design Symbol "A". High quality malleable cast iron fittings have been manufactured by Trakya Döküm since 1982 using modern machinery and equipment.

The fittings production line is equipped with a Disamatic 2013 Mk 4, Junker Presspour and main frequency melting furnaces. Special care has been taken to select modern sophisticated technology from Western Europe and the USA in all sections of sand preparation, core-making, fettling, heat treatment, galvanising, thread-cutting, laboratories and pattern-making, enabling the company to produce superior cast iron fittings for sales all around the world.

Product Standards

Trakya Döküm malleable cast iron fittings are in accordance with the current ISO 49 and EN 10242 standards and are designated with the design symbol A.

Threads

Basic fitting threads are jointing threads, where ISO 7-1 applies. Internal threads are parallel and external threads are 1:16 taper. Threads, which are fastening threads according to ISO 228/1.

Surface Finish

Trakya Döküm malleable cast iron fittings are provided in black or hot dip galvanised finish, covered with a preservative for temporary prevention of rust film. Trakya Döküm fittings can be delivered in black or galvanised finish as requested by the purchaser. As prescribed by the standard EN10242, the mass of zinc coating shall not be less than 500gr/m² which corresponds to a medium layer thickness of 70 µm.



CARBON STEEL FITTINGS

Sardoğan has been involved in production of butt-welded pipe fittings and flanges from carbon steel. Fittings and flanges with brand names of Sardoğan and SRD are manufactured under ISO 9001:2000 Quality Management System as well as certificate of Assessment of Manufacturer Material by Bureau Veritas. All the products in Sardoğan are accredited by the official notified body of Turkey, Turkish Standards Institution (TSE).

Products

REDUCER

- DIN 2616
- TS 2649/7
- EN 10253-1

FLAT FLANGES

- PN 6 EN 1092-1
- PN 10 EN 1092-1
- PN 16 EN 1092-1

TEE

- DIN 2615
- TS 2649/6
- TS EN 10253-1

ELBOW

- DIN 2605 3 D
- TS 2649/1-A
- EN 10253-1

WELDING NECK FLANGES

- PN 16 EN 1092-1
- PN 40 EN 1092-1

CAP

- DIN 2617
- TS EN 10253-1
- TS 2649/5

ELBOW

- ASME/ASTM A 234
- ANSI B16.9
- SCH 40 & SCH80
- LONG RADIUS

SLIP-ON FLANGES

- ASA 150 LB
- ANSI B 16.5
- TS EN 1759-1

COUPLING

- EN10241

PIPE CLAMPS

Zer Kelepçe exports to more than 50 countries in 5 continents and continues its activities in Istanbul with an 8000 m² production area. The company adds value to your business with our engineering and production power in bridges, highways, airports, constructions and all sectors where it is used. In the field of clamp manufacturing, we offer the most suitable product options to our customers in different sectors and help them achieve maximum efficiency with minimum operating costs. The company brings quality together with their expertise with galvanised coating facility, rubber pvc seal facility and screw-bolt facility.

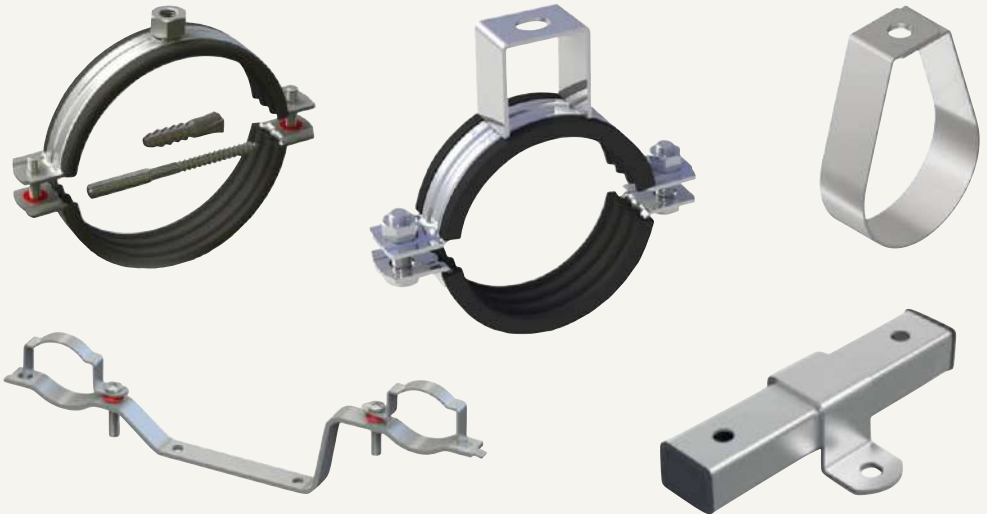

PROFILES & SECTIONS

Yücel Boru ve Profil, Turkey's leading steel tubes and hollow sections producer, started production in 1969 and since then it produces construction profiles, special shaped profiles. Construction profiles include square & rectangular profiles. Special shaped profiles include oval, ellipse, D profiles, L, T, Z, I, X, hexagon, drops, railing section profiles.

Production Standards

Square and Rectangular Hollow Sections

- TS EN 10305-5, TS EN 10219-1/2 , TS 5317, ASTM
- A500, AS/NZS 1163

Tubes

- TS EN 10305-3, TS EN 10219-1/2 , TS 8481 EN 39
- AS/NZS 1163, TS EN 10255+A1
- CE certified for TS EN 10219 and TS EN 10255+A1

Material Qualities

TS EN 10219

- S235JR, S275J0, S275J2, S275MH, S355J0, S355J2, 355K2, S355MH, S420MH, S460MH

TS EN 10305-3 / 5

- E155, E195, E235, E275, E355 (+CR1,+A,+N) / E190, E220, E260, E320, E370, E420

(+Cr2) Surface Condition

- S1,S2,S3 ve S4 AS / NZS 1163: C250, C250L0, C350, C350L0,

C450, C450L0 ASTM A500

- GrA, GrB, GrC, GrD

TS EN 10219-2		YAPISAL ÇELİK PROFİLLER-DİKİŞLİ ALAŞIMSIZ İNCE TANELİ ÇELİKLERDEN SOĞUK ŞEKLİLENDİRİLEREK KAYNAK EDİLMİŞ COLD FORMED WELDED STRUCTURAL HOLLOW SECTIONS OF NON-ALLOY AND FINE GRAIN STEELS											
Kenar Uzunluğu Side length (mm)		Et Kalınlık / Wall thickness, T (mm)											
		1,4	1,5	2	2,5	3	4	5	6	6,3	8	10	
B/H	B	Birim Uzunluk Kütle / Mass Per Unit Length, (kg/m)											
10	10	0,338	0,355										
15	10	0,448	0,473										
	15	0,558	0,590										
18	18	0,690	0,732	0,924									
20	20	0,778	0,826	1,05	1,25								
25	15	0,778	0,826	1,05	1,25								
	25	0,778	0,826	1,05	1,25								
30	10	0,778	0,826	1,05	1,25								
	20	0,998	1,06	1,36	1,64	1,89							
	30	0,778	0,826	1,05									
40	20	0,998	1,06	1,36	1,64	1,89							
	25	1,22	1,30	1,68	2,03	2,36							
	30	1,22	1,30	1,68	2,03	2,36							
45	40	1,33	1,41	1,83	2,23	2,60							
	45	1,44	1,53	1,99	2,42	2,83							
50	20	1,44	1,53	1,99	2,42	2,83							
	25	1,55	1,65	2,15	2,62	3,07	3,88						
	30	1,66	1,77	2,31	2,82	3,30	4,20						
	40	1,88	2,00	2,62	3,21	3,77	4,83						
60	50	2,10	2,24	2,93	3,60	4,25	5,45	6,56					
	20	1,66	1,77	2,31	2,82	3,30	4,20						
	30	1,88	2,00	2,62	3,21	3,77	4,83						
	40	2,10	2,24	2,93	3,60	4,25	5,45	6,56					
70	60	2,54	2,71	3,56	4,39	5,19	6,71	8,13					
	30	2,10	2,24	2,93	3,60	4,25	5,45	6,56					
	40	2,32	2,47	3,25	3,99	4,72	6,08	7,34					
	50	2,54	2,71	3,56	4,39	5,19	6,71	8,13					
80	70	2,98	3,18	4,19	5,17	6,13	7,97	9,70					
	30	2,32	2,47	3,25	3,99	4,72	6,08	7,34					
	40	2,54	2,71	3,56	4,39	5,19	6,71	8,13					
	60	2,98	3,18	4,19	5,17	6,13	7,97	9,70					
90	80			4,82	5,96	7,07	9,22	11,3	13,2				
	50	2,98	3,18	4,19	5,17	6,13	7,97	9,70					
	90			5,45	6,74	8,01	10,5	12,8	15,1				
100	40	2,98	3,18	4,19	5,17	6,13	7,97	9,70					
	50	3,20	3,42	4,50	5,56	6,60	8,59	10,5					
	60			4,82	5,96	7,07	9,22	11,3	13,2				
	80			5,45	6,74	8,01	10,5	12,8	15,10				
110	100			6,07	7,53	8,96	11,7	14,4	17,0	17,5	21,4		
	30	2,98	3,18	4,19	5,17	6,13	7,97	9,70					
	40	3,42		4,82	5,96	7,07	9,22	11,3	13,2				
	60	3,86		5,45	6,74	8,01	10,5	12,8	15,1				
120	80	4,29		6,07	7,53	8,96	11,7	14,4	17,0		21,4		
	100	4,73		6,70	8,31	9,90	13,0	16,0	18,9		23,9		
	120			7,33	9,10	10,8	14,2	17,5	20,7	21,4	26,4		
	60			6,07	7,53	8,96	11,7	14,4	17,0		21,4		
140	80			6,70	8,31	9,90	13,0	16,0	18,9		23,9		
	50				7,53	8,96	11,7	14,4	17,0		21,4		
150	100					11,3	14,9	18,3	21,7		27,7		
	150						13,7	18,0	22,3	26,4	27,4	33,9	
160	80				9,10	10,8	14,2	17,5	20,7		26,4		
175	175						16,0	21,2	26,2	31,1		40,2	
	100						13,7	18,0	22,3	26,4		33,9	
200	150						16,0	21,2	26,2	31,1		40,2	
	200								30,1	35,8		46,5	57,0
250	100							21,2	26,2	31,1		40,2	
	150								30,1	35,8		46,5	57,0
300	250								45,2			59,1	72,7
	200								45,2			59,1	72,7

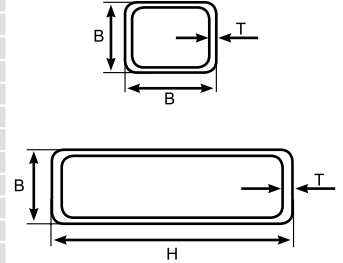

TS EN 10305-5		ÇELİK PROFİLLER-HASSAS UYGULAMALAR İÇİN-SOĞUK ÖLÇÜLENDİRİLMİŞ DİKİSLİ KARE VE DİKİDÖRTGEN KESİTLİ BORULAR STEEL TUBES FOR PRECISION APPLICATIONS-WELDED COLD SIZED SQUARE AND RECTANGULAR TUBES												
Kenar Uzunluğu Side length (mm)		Et Kalınlık / Wall thickness, T (mm)												
		0,7	0,8	0,9	1	1,2	1,25	1,5	2	2,5	3	4		
B/H	B	Birim Uzunluk Kütlesi / Mass Per Unit Length, (kg/m)												
10	10	0,204	0,230	0,256	0,281	0,329	0,341							
15	15	0,313	0,356	0,397	0,438	0,518	0,537	0,632						
20	10	0,313	0,356	0,397	0,438	0,518	0,537	0,632						
	15	0,368	0,418	0,468	0,516	0,612	0,635	0,750	0,967					
20	20	0,423	0,481	0,538	0,595	0,706	0,733	0,868	1,12	1,36				
	15	0,423	0,481	0,538	0,595	0,706	0,733	0,868	1,12	1,36				
25	25	0,533	0,607	0,680	0,752	0,894	0,930	1,10	1,44	1,76	1,92			
	10	0,423	0,481	0,538	0,595	0,706	0,733	0,868	1,12					
30	15	0,478	0,544	0,609	0,673	0,800	0,831	0,985	1,28					
	20	0,533	0,607	0,680	0,752	0,894	0,930	1,10	1,44	1,76	1,92			
	30	0,643	0,732	0,821	0,909	1,08	1,13	1,34	1,75	2,15	2,39			
35	20				0,830	0,989	1,03	1,22	1,59	1,95				
	25				0,909	1,08	1,13	1,34	1,75	2,15				
	35				1,07	1,27	1,32	1,57	2,07	2,54	2,86			
40	20	0,643	0,732	0,821	0,909	1,08		1,34	1,75	2,15	2,39			
	25		0,795	0,892	0,987	1,18		1,46	1,91	2,34	2,63			
	30		0,858	0,962	1,07	1,27		1,57	2,07	2,54	2,86			
40	40			1,10	1,22	1,46		1,81	2,38	2,93	3,33	4,25		
	45					1,65		2,05	2,69	3,33	3,81	4,88		
50	20		0,858	0,962	1,07	1,27		1,57	2,07	2,54	2,86			
	25			1,03	1,14	1,37		1,69	2,22	2,74	3,10	3,94		
	30			1,10	1,22	1,46		1,81	2,38	2,93	3,33	4,25		
	40					1,65		2,04	2,69	3,33	3,81	4,88		
60	50					1,84		2,28	3,01	3,72	4,28	5,51		
	20			1,10	1,22	1,46		1,81	2,38	2,93	3,33	4,25		
	30					1,65		2,05	2,69	3,33	3,81	4,88		
	40					1,84		2,28	3,01	3,72	4,28	5,51		
	50					2,02		2,52	3,32	4,11	4,75	6,14		
70	60					2,21		2,75	3,64	4,50	5,22	6,76		
	30					1,84		2,28	3,01	3,72	4,28	5,51		
	40					2,02		2,52	3,32	4,11	4,75	6,14		
	50					2,21		2,75	3,64	4,50	5,22	6,76		
	70							3,22	4,26	5,29	6,16	8,02		
80	20					1,84		2,28	3,01	3,72	4,28	5,51		
	30					2,02		2,52	3,32	4,11	4,75	6,14		
	40					2,21		2,75	3,64	4,50	5,22	6,76		
	50							2,99	3,95	4,90	5,69	7,39		
	60							3,223	4,26	5,29	6,16	8,02		
90	80							4,89	6,07	7,10	9,28			
	50							3,22	4,26	5,29	6,16	8,02		
	90							5,52	6,86	8,04	10,5			
100	40							3,22	4,26	5,29	6,16	8,02		
	50							3,46	4,58	5,68	6,63	8,65		
	60							4,89	6,07	7,10	9,28			
	80							5,52	6,86	8,04	10,5			
120	100							6,15	7,64	8,99	11,8			
	40							4,89	6,07	7,10	9,28			
	60							5,52	6,86	8,04	10,5			
	80							6,15	7,64	8,99	11,8			
140	120							7,40	9,21	10,9	14,3			
	60							6,15	7,64	8,99	11,8			
	80							6,78	8,43	9,93	13,0			
150	50								7,64	8,99	11,8			
	100									11,3	14,9			
	150										13,7	18,1		
160	80								9,21	10,9	14,3			
175	175										16,1	21,2		
200	100										13,7	18,1		
	150										16,1	21,2		
250	100											21,2		

AS / NZS 1163	SOĞUK ŞEKİLLENDİRİLMİŞ YAPISAL KARE KESİTLİ ÇELİK PROFİLLER COLD FORMED STRUCTURAL STEEL HOLLOW SECTIONS							
Ebat Dimensions b x b (mm)	Et Kalınlık / Wall thickness, t (mm)							
	1,60	2,00	2,50	3,00	3,50	4,00	5,00	6,00
Birim Uzunluk Kütlesi / Mass Per Unit Length, (kg/m)								
20	0,873							
25	1,12	1,36	1,64	1,89				
30	1,38	1,68						
35	1,63	1,99	2,42	2,83				
40	1,88	2,31	2,82			4,09		
50	2,38	2,93	3,60	4,25		5,35		
65		3,88	4,78	5,66				
75			5,56	6,60	7,53	8,49	10,3	12,0
89					9,06		12,5	14,6
100			8,96			11,6	14,2	16,7
125						14,8	18,2	21,4
150							22,1	26,2

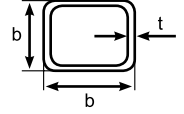

AS / NZS 1163	SOĞUK ŞEKİLLENDİRİLMİŞ YAPISAL DİKDÖRTGEN KESİTLİ ÇELİK PROFİLLER COLD FORMED STRUCTURAL STEEL HOLLOW SECTIONS								
Ebat Dimensions d x b (mm)	Et Kalınlık / Wall thickness, t (mm)								
	1,6	2,0	2,5	3,0	3,5	4,0	5,0	6,0	
Birim Uzunluk Kütlesi / Mass Per Unit Length, (kg/m)									
d	b								
50	20	1,63	1,99	2,42	2,83				
50	25	1,75	2,15	2,62	3,07				
65	35		2,93	3,60	4,25				
75	25	2,38	2,93	3,60					
75	50		3,72	4,58	5,42	6,92			
100	50		4,50	5,56	6,60	7,53	8,49	10,3	
125	75				8,96		11,6	14,2	
150	50				8,96		11,6	14,2	
150	100						14,8	18,2	
200	100						17,9	22,1	

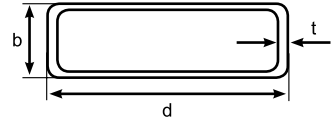

BOYALI ÜRÜN PORTFÖYÜMÜZ / PAINTED PRODUCTS PORTFOLIO			
	EBAT / SIZE (mm)	KALINLIK / THICKNESS (µm)	UZUNLUK / LENGTH (mm)
BORU CIRCULAR HOLLOW SECTION	13 ~ 219,1	1,2 ~ 9	4 ~ 13
PROFİL SQUARE AND RECTANGULAR HOLLOW SECTION	15 X 15 ~ 250 X 250		
	20 X 10 ~ 200 X 150		



PLASTIC BASED PRODUCTS

Firat was established to carry out production in the field of plastic building materials in the year 1972. Firat, which always sets out with the principles of quality production and product diversity, has succeeded in becoming both the leading establishment of the sector and the export leader of the sector as a result of significant enterprises that have taken years. Firat proudly owns one of the three biggest plastic production complexes in Europe.

Sanitary Piping Systems

- Sewage Piping Systems
- Cold and Hot Water Pipe Systems
- Metal Systems
- Pre-Insulated Multilayer Pipes
- Pex Al Pex Tig Pipes
- Polyethylene 32 Pipes

Drainage Pipe Systems

- PVC Drainage Systems
- PE Drainage Ststems
- Tunnel Type Drainage Pipes

Infrastructure Pipes

- Potable Water Systems
- Sewarage Pipe Systems

PVC Hoses

- Suction / Transport Hoses
- Flex - Transparent Hoses
- Garden Hoses
- Gas Hoses
- Water Inlet and Discharge Hoses
- Thermo Hoses
- Fire Hoses



PLASTIC PIPES & FITTINGS

Wavin Pilsa is a leading firm in the Plastic Pipe sector in Turkey. The company has been presenting services of quality pipes, fittings and solutions in water management, heating and cooling, water and gas distribution and wastewater drainage. They offer a complete, competitive, innovative and sustainable portfolio to customers by setting the highest standards for safety and hygiene. Wavin Pilsa offers conventional pipe systems such as PPRC, Pex, Composite Pipe, PE 100 Pipes. Additionally, different value-added products are also offered such as SiTech low noise systems, Quickstream Siphonic rainwater discharge systems, Tegra injections manholes, Tigris press-fit systems, Chemidro Underfloor heating systems.



FIRE SAFETY PRODUCTS

Acco has been established to manufacture fire cabinets and mobile fire extinguishing equipment to serve the requirements and purpose of use in buildings, combining the knowledge of its founders about the sector and their innovative approach based on research and development.

Products

- Fire Hose Reels
- Fire Cabinets with Semi-Rigid Hose
- Fire Cabinets with Lay Flat Hose
- Fire Extinguishers
- Fire Hydrants
- Foam Cabinets
- Mobile Units
- Automatic Fire Extinguishing Systems
- Fire Monitors
- Tunnel Cabinets
- Fire Equipment Cabinets
- Flammable Material Transport - Handling - Storage Units
- Fire Hoses and Accessories

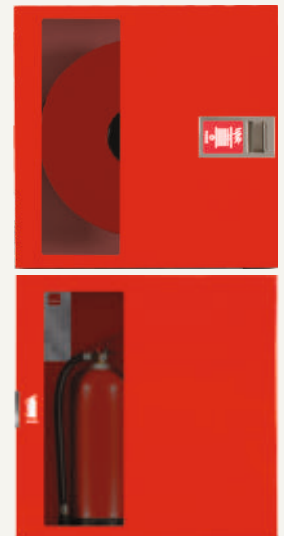

VALVES

E.C.A. started production under the trademark of E.C.A. in 1957 and the group operates 14 factories and 21 companies in the heating and building industries. Their product range includes bathroom and plumbing products including mixers, plumbing and natural gas valves, ceramic sanitary ware, acrylic bathtubs, built-in reservoirs, ceramic coating materials, bathroom accessories and heating and cooling systems including combi boilers, central heating systems and radiators.



INSULATION PRODUCTS

Izocam is currently the leading isolation company in Turkey with its wide range of products and technical consultancy services that offer protection against heat, cold, noise, fire and water. It meets its customers' demands and expectations in a timely and environmentalist manner in accordance with globalising world standards. Izocam implements ISO 9001 Quality Assurance System, ISO 14001 Environmental Management System and OHSAS 18001 Occupational Health and Safety System in its facilities. Izocam's mineral wool products have the EUCEB certificate, given only for stone wool and glass wool in the bio products category. The company also holds Eurofins Gold certificate for Roof Blanket and Rulopan products, which confirms compliance with national emission limits of the EU state.

Products

- Roof Insulation
- Wall Insulation
- Floor Insulation
- HVAC Insulation
- Industrial Insulation
- Technical Insulation



Product Group

- Glass Wool
- Stone Wool
- Extruded Polystyrene (XPS)
- Expanded Polystyrene (EPS)
- Elastomeric Rubber
- Polyethylene

CERAMIC TILES

Güral Seramik aims to express itself through its art, craftsmanship, quality and success. Combining perfection and elegance, Güral Seramik presents comfort to your eyes. Güral Seramik's site is 160.000 m² and its expanding area is nearly 500.000 m². Güral Seramik shapes its magnificent designs with innovative ideas and the latest technology. The factory has extraordinary production flexibility with its technology suitable for industry 4.0.

Categories

- Concrete
- Decor
- Natural Stone
- Marble
- Wood



SANITARY WARE

Güral Vit was formed in 1995 to produce sanitary ware, mixers, bathroom accessories, bathroom sets, shower sets and bathroom furniture. Manufacturing capacity is now in excess of 1.200.000 main pieces per annum.

Gural sanitary ware products have the approval of ISO, NF (France), DIN Certificate (German) and Standart & Mark (Australia) certificates.



STAKEHOLDERS



GÜRAL SERAMİK

GÜRAL | VİT

ELAN

A: Beştepe Mahallesi Dumlupınar Bulvarı No: 6-1/18 Yenimahalle – Ankara / Türkiye 06560
T: +90 312 295 62 57 **@:** info@elantr.com **W:** www.elantr.com

